

**5. KOLANO NYPLOWE 90 °
(Ri-Ra)**

Gwint wewnętrzny / zewnętrzny, DIN 2987,
wykonane ze stali 316.

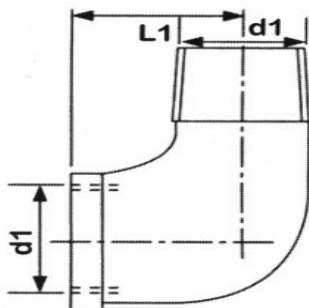

Charakterystyka:

NW	d1 (mm)	L1 (mm)
6	1/8"	18
8	1/4"	21
10	3/8"	24
15	1/2"	28
20	3/4"	33
25	1"	38
32	1 1/4"	45
40	1 1/2"	49
50	2"	57
65	2 1/2"	68
80	3"	80
100	4"	130